



Product Guide

Honeycomb Collection



Features

QMotion® offers state-of-the-art natural light control with the following benefits:



day, day of week, sunrise, or sunset. Create six distinct settings and let the shades do the rest.

- *Want to control multiple shades with just one remote?* QMotion® multi-channel remote controls 6 individual shades or 6 groups of shades all with one remote control. Each channel can have an unlimited number of shades programmed to it.
- *Controlling roller shades and honeycomb shades?* Qmotion® transmitters can control both Honeycomb and Roller shades from Qmotion®. Move them together by putting them on the same button, or separately using different controls or buttons.

Unmatched quietness

- QMotion® engineers developed a honeycomb shade with whisper quiet operation for a beautiful and peaceful experience, combined with excellent insulating benefits.

Several different control options

- QMotion® Honeycomb Shades offer the convenience of moving the shade up or down, stopping at any of the top, the bottom, three programmable intermediate stops, or anywhere in between; all with the ease of a button press.
- *Lose your remote? No problem!* QMotion® Honeycomb Shades can be moved up or down manually with no remote control. Simply give the shade a gentle pull to get them started.
- *Interested in reducing your energy bills?* The programmable timer remote can be set up to move your QMotion® Honeycomb shade automatically. Automate your shades by time of





Designs

QMotion® delivers beautiful design options that compliment any room.

Distinctive designs

- Generous fabric collection of light filtering, decorative and beautiful blackout materials.
- Honeycomb construction provides superior insulation and energy efficiency.
- No visible cords or cord holes reduces light leaks and adds to the fashionable appeal.
- All QMotion® Honeycombs, both manual and Automated, are cord-less, offering aesthetic and safety benefits as a standard.
- Fabric available in wide widths to cover large expansive windows with no seams or overlap.
- Neutral white backing provides a uniform appearance to the outside of the home.
- Multiple design options and operating systems available to provide the perfect solution for the single home-owner to the busiest family.
- Wide range of decorative styles, including soft solids and bold prints, make for a gorgeous collection.
- Integrated light blocking wool pile for inside mount shades.

Upgradeable from Manual to Automated

- QMotion® Honeycomb shades are available in a fully cordless manual shade, with the aesthetic and child safety benefits as a standard. Or, select Automated. Manual honeycomb shades from Qmotion can be upgraded, easily, at any time.





Fabric Choices

QMotion® honeycomb shades give you the flexibility you desire.

The honeycomb collection features beautiful, high-quality fabrics that add warmth and a designer style to your home’s décor.

- For deep, vibrant and consistent color in a woven fabric, choose the 3/4” Woven in a translucent or blackout.
- Choose one of the 3/4” rich colors for a luxuriously soft fabric for your window.
- Consider the 3/4” Sheer or Semi-Sheer fabric selection for a fresh look and open view to the outside.
- Popular 3/4” Textured or Classic fabrics come in translucent or blackout.
- Double Cell Texture and Classic colors are available in translucent.

Honeycomb shades come in 4 fabric types, sheer, semi-sheer, translucent, and blackout. Each offers a different degree of privacy and light control.

Sheer and Semi-Sheer Fabrics

- Transmit light with view through the shade
- Do not provide privacy
- Available in 3/4” Single Cell Fabrics

Translucent Fabrics

- Transmit filtered light with no view through the shade
- Provide moderate privacy
- Available in 3/4” Single Cell and Double Cell fabrics

Blackout Fabrics

- Blocks 99% of outside light
- Provides complete privacy and light control
- Available in 3/4” Single Cell and Double Cell fabrics

Energy Efficiency

Honeycomb shades are among the most energy-efficient window coverings available. The insular property of honeycomb fabric is attributed to its unique cellular construction creating a barrier of chambers designed to reduce heat and the damaging effects of UV light.

Customization that’s right for you

- Choose from our assortment of remote controls. Among the choices is our programmable timer control which allows for setting of times for unattended shade movement or our multichannel remote to control various shade groups from a single hand held transmitter. All transmitters fit on our magnetic wall docking stations, and may be secured in place using our wall station adapter.
- As our programming is simple, all shades arrive ready to “learn” to your remotes. A shade may be controlled by as many as 12 different transmitters.
- Qmotion Honeycomb Shades can use the same remotes as Qmotion Roller Shades, providing unique control options.
- Combine groups and transmitters for your convenience. A channel can be for a single shade or a group of shades, and various groups can be programmed to suit the space.



Accent Colors

QMotion® helps you bring out the beauty of your fabric by offering you these luxurious headrail and bottom rail colors that accentuate the look of your shades.

Terracotta



Periwinkle



Jasmine



Cashmere



Brilliant White



Chestnut Bronze



Linen White



Midnight Black



Ash Gray





Outer Dimensions and Stack Height

Inside Mount_Outer Dimensions Front View

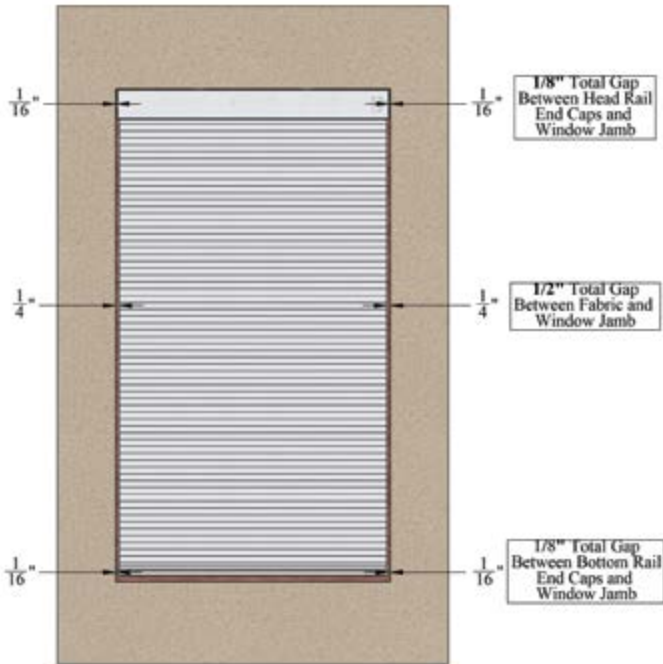

Outside Mount_Outer Dimensions Front View

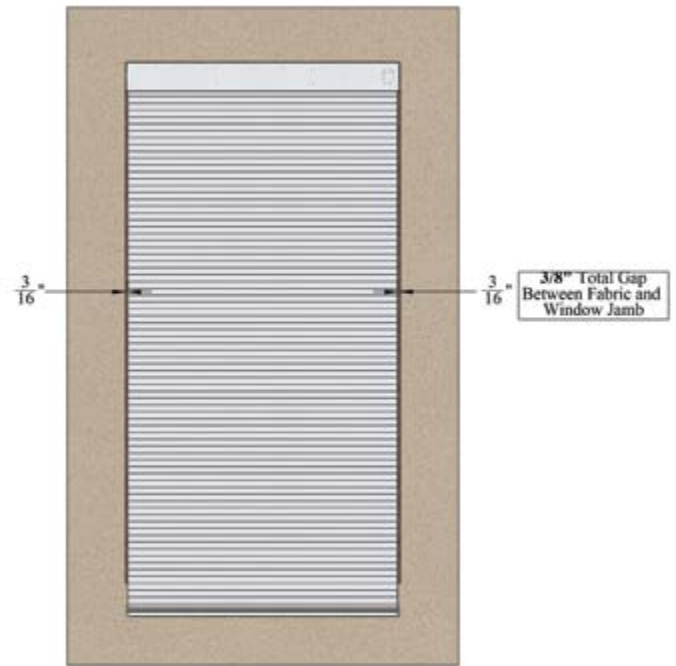

Stack Height

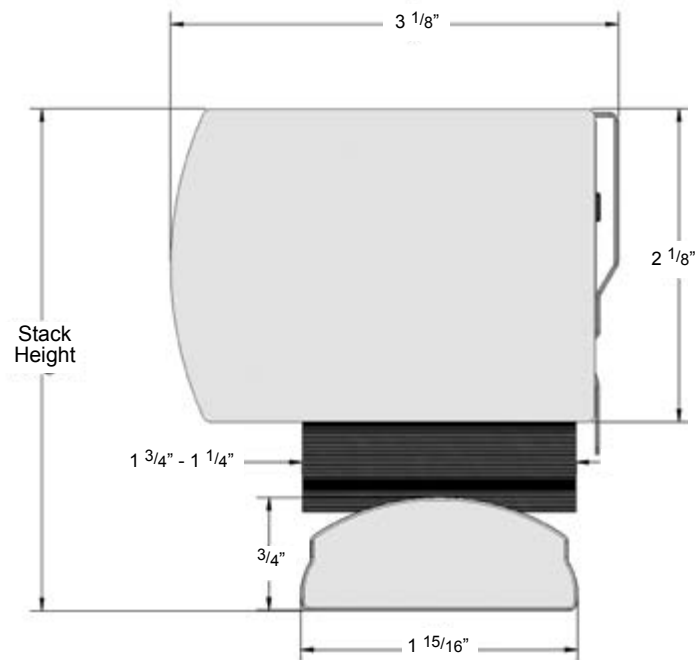

Fabric stack will vary depending on shade height and selected fabrics. Please see Fabric charts for complete shade heights including the fabric.



Shade Size Specifications

Fabric Selections (Charts on the following 4 pages):

Color Name	Fabric Type	Part #	Header/Bottom Rail Color	Price Chart	Approx. Stack Height (in inches)						Height		Width	
					24"	48"	60"	72"	84"	96"	Min.	Max.	Min.	Max.
Canyon	Double Cell Translucent	82T0013	Bronze	C	3 ⁷ / ₈	4 ² / ₈	4 ² / ₈	5 ¹ / ₈	5 ⁴ / ₈	5 ⁷ / ₈	20"	84"	20"	54"
Cloud	Double Cell Translucent	82T0014	Brilliant White	C										
Pearl	Double Cell Translucent	82T0015	Linen White	C										
Sunset	Double Cell Translucent	82T0016	Jasmine	C										
Maize	Double Cell Translucent	82T0017	Cashmere	C										
Leather	Double Cell Translucent	82T0018	Cashmere	C										
Fresh Air	Double Cell Translucent	82T0019	Linen White	C										
Tiger's Eye	Double Cell Translucent	82T0020	Jasmine	C										
Mint	3/4" Translucent	82T0021	Linen White	A	3 ⁵ / ₈	3 ⁷ / ₈	4 ² / ₈	4 ⁴ / ₈	4 ⁷ / ₈	5 ¹ / ₈	20"	84"	20"	84"
Cloud	3/4" Translucent	82T0022	Brilliant White	A										
Desert Sand	3/4" Translucent	82T0023	Cashmere	A										
Pearl	3/4" Translucent	82T0024	Linen White	A										
Eggshell	3/4" Translucent	82T0025	Linen White	A										
Banana Pudding	3/4" Translucent	82T0026	Cashmere	A										
Leather	3/4" Translucent	82T0027	Cashmere	A										
Spring Green	3/4" Translucent	82T0028	Linen White	A										
Silver	3/4" Translucent	82T0029	Ash Gray	A										
Mercury	3/4" Translucent	82T0030	Ash Gray	A										
Cottage White	3/4" Translucent	82T0031	Linen White	A										
Citrine	3/4" Translucent	82T0032	Jasmine	A										
Marble	3/4" Room Darkening	82T0033	Brilliant White	D	3 ⁵ / ₈	4	4 ² / ₈	4 ⁵ / ₈	4 ⁷ / ₈	5 ² / ₈	20"	84"	20"	54"
Canvas	3/4" Room Darkening	82T0034	Jasmine	D										
Haystack	3/4" Room Darkening	82T0035	Cashmere	D										
Asparagus	3/4" Room Darkening	82T0036	Linen White	D										
Bronze	3/4" Room Darkening	82T0037	Cashmere	D										
Brick	3/4" Room Darkening	82T0038	Terra Cotta	D										
Ash	3/4" Room Darkening	82T0039	Cashmere	D										
Milk	3/4" Room Darkening	82T0040	Brilliant White	D										
Oyster	3/4" Room Darkening	82T0041	Cashmere	D										
French Roast	3/4" Room Darkening	82T0042	Bronze	D										
Coal	3/4" Room Darkening	82T0043	Black	D										
Shamrock	3/4" Room Darkening	82T0044	Linen White	D										



Shade Size Specifications

Fabric Selections

Color Name	Fabric Type	Part #	Header/Bottom Rail Color	Price Chart	Approx. Stack Height (in inches)						Height		Width	
					24"	48"	60"	72"	84"	96"	Min.	Max.	Min.	Max.
Marble	Double Cell Room Darkening	82T0045	Linen White	D	3 ⁵ / ₈	3 ⁷ / ₈	4 ² / ₈	4 ⁴ / ₈	4 ⁷ / ₈	5 ¹ / ₈	20"	84"	20"	54"
Gold	Double Cell Room Darkening	82T0046	Jasmine	D										
Haystack	Double Cell Room Darkening	82T0047	Cashmere	D										
Brick	Double Cell Room Darkening	82T0048	Terra Cotta	D										
Milk	Double Cell Room Darkening	82T0049	Brilliant White	D										
Bone	Double Cell Room Darkening	82T0050	Cashmere	D										
French Roast	Double Cell Room Darkening	82T0051	Bronze	D										
Shamrock	Double Cell Room Darkening	82T0052	Linen White	D										
Tusk	3/4" Semi Sheer	82T0061	Jasmine	F	3 ⁶ / ₈	4 ¹ / ₈	4 ³ / ₈	4 ⁶ / ₈	5 ¹ / ₈	5 ⁴ / ₈	20"	84"	20"	66"
Veil White	3/4" Semi Sheer	82T0062	Brilliant White	F										
Floral White	3/4" Semi Sheer	82T0063	Brilliant White	F										
Champange	3/4" Semi Sheer	82T0064	Cashmere	F										
Cornflower	3/4" Sheer	82T0065	Periwinkle	F										
Snowflake	3/4" Sheer	82T0066	Brilliant White	F	3 ³ / ₈	3 ⁴ / ₈	3 ⁶ / ₈	3 ⁷ / ₈	4	4 ² / ₈	20"	84"	20"	108"
Old Lace	3/4" Sheer	82T0067	Linen White	F										
Corn Silk	3/4" Sheer	82T0068	Cashmere	F										
Morning Dew	3/4" Sheer	82T0069	Linen White	F										
Licorice	3/4" Sheer	82T0070	Black	F										
Sugar	Double Cell Translucent	82T0071	Brilliant White	E	3 ³ / ₈	3 ⁵ / ₈	3 ⁷ / ₈	4	4 ² / ₈	4 ⁴ / ₈	20"	84"	20"	66"
Pistachio	Double Cell Translucent	82T0072	Linen White	E										
Sunglow	Double Cell Translucent	82T0073	Jasmine	E										
Seagull	Double Cell Translucent	82T0074	Linen White	E										
Russet	Double Cell Translucent	82T0075	Cashmere	E										
Caribbean	Double Cell Translucent	82T0076	Periwinkle	E										
Wheat	Double Cell Translucent	82T0077	Jasmine	E										
Quartz	Double Cell Translucent	82T0078	Linen White	E										
Cotton	Double Cell Translucent	82T0079	Brilliant White	E										
Vanilla	Double Cell Translucent	82T0080	Cashmere	E										
Sugar	3/4" Translucent	82T0081	Brilliant White	B	3 ² / ₈	3 ³ / ₈	3 ⁴ / ₈	3 ⁵ / ₈	3 ⁷ / ₈	4	20"	84"	20"	102"
Tumbleweed	3/4" Translucent	82T0082	Cashmere	B										
Sunglow	3/4" Translucent	82T0083	Jasmine	B										
Burnt Umber	3/4" Translucent	82T0084	Cashmere	B										



Shade Size Specifications

Fabric Selections

Color Name	Fabric Type	Part #	Header/Bottom Rail Color	Price Chart	Approx. Stack Height (in inches)						Height		Width			
					24"	48"	60"	72"	84"	96"	Min.	Max.	Min.	Max.		
Toasted Pecan	3/4" Translucent	82T0085	Cashmere	B												
Russet	3/4" Translucent	82T0086	Cashmere	B	3 ² / ₈	3 ³ / ₈	3 ⁴ / ₈	3 ⁵ / ₈	3 ⁷ / ₈	4	20"	84"	20"	102"		
Sepia	3/4" Translucent	82T0087	Bronze	B												
Olive	3/4" Translucent	82T0088	Linen White	B												
Saddle	3/4" Translucent	82T0089	Cashmere	B												
Wheat	3/4" Translucent	82T0090	Jasmine	B	3 ² / ₈	3 ³ / ₈	3 ⁴ / ₈	3 ⁵ / ₈	3 ⁷ / ₈	4	20"	84"	20"	102"		
Cotton	3/4" Translucent	82T0091	Brilliant White	B												
Vanilla	3/4" Translucent	82T0092	Cashmere	B												
Marsh	3/4" Translucent Print	82T0093	Cashmere	B												
Windsong	3/4" Translucent Print	82T0094	Jasmine	B	3 ² / ₈	3 ³ / ₈	3 ⁴ / ₈	3 ⁵ / ₈	3 ⁷ / ₈	4	20"	84"	20"	102"		
Khaki	3/4" Translucent Print	82T0095	Cashmere	B												
Bonfire	3/4" Translucent Print	82T0096	Terra Cotta	B												
Sapphire	3/4" Room Darkening	82T0097	Linen White	D												
Amethyst	3/4" Room Darkening	82T0098	Linen White	D												
Ghost	3/4" Room Darkening	82T0099	Brilliant White	D												
Tumbleweed	3/4" Room Darkening	82T0100	Jasmine	D												
Sunglow	3/4" Room Darkening	82T0101	Jasmine	D												
Sepia	3/4" Room Darkening	82T0102	Bronze	D	3 ³ / ₈	3 ⁴ / ₈	3 ⁶ / ₈	3 ⁷ / ₈	4 ¹ / ₈	4 ² / ₈	20"	84"	20"	66"		
Olive	3/4" Room Darkening	82T0103	Cashmere	D												
Steel Blue	3/4" Room Darkening	82T0104	Periwinkle	D												
Downy	3/4" Room Darkening	82T0105	Cashmere	D												
Cotton	3/4" Room Darkening	82T0106	Linen White	D												
Iceberg	3/4" Room Darkening	82T0107	Periwinkle	D												
Vanilla	3/4" Room Darkening	82T0108	Cashmere	D												
Star Dust	Double Cell Tusco	82T0109	Brilliant White	C												
Pina Colada	Double Cell Tusco	82T0110	Linen White	C												
Opal	Double Cell Tusco	82T0111	Linen White	C												
Lion's Mane	Double Cell Tusco	82T0112	Jasmine	C	3 ⁵ / ₈	4	4 ³ / ₈	4 ⁵ / ₈	5	5 ³ / ₈	20"	84"	20"	66"		
Seaweed	Double Cell Tusco	82T0113	Cashmere	C												
Summer Field	Double Cell Tusco	82T0114	Cashmere	C												
Tuscan Red	Double Cell Tusco	82T0115	Terra Cotta	C												
Denim	Double Cell Tusco	82T0116	Periwinkle	C												



Shade Size Specifications

Fabric Selections

Color Name	Fabric Type	Part #	Header/Bottom Rail Color	Price Chart	Approx. Stack Height (in inches)						Height		Width	
					24"	48"	60"	72"	84"	96"	Min.	Max.	Min.	Max.
Star Dust	3/4" Translucent Tusco	82T0117	Brilliant White	A	3 ^{3/8}	3 ^{5/8}	3 ^{6/8}	4	4 ^{1/8}	4 ^{3/8}	20"	84"	20"	102"
Pina Colada	3/4" Translucent Tusco	82T0118	Linen White	A										
Opal	3/4" Translucent Tusco	82T0119	Cashmere	A										
Lion's Mane	3/4" Translucent Tusco	82T0120	Jasmine	A										
Seaweed	3/4" Translucent Tusco	82T0121	Cashmere	A										
Summer Field	3/4" Translucent Tusco	82T0122	Cashmere	A										
Tuscan Red	3/4" Translucent Tusco	82T0123	Terra Cotta	A										
Denim	3/4" Translucent Tusco	82T0124	Periwinkle	A										
Star Dust	3/4" Room Darkening Tusco	82T0125	Brilliant White	C	3 ^{3/8}	3 ^{5/8}	3 ^{7/8}	4	4 ^{2/8}	4 ^{4/8}	20"	84"	20"	72"
Pina Colada	3/4" Room Darkening Tusco	82T0126	Linen White	C										
Opal	3/4" Room Darkening Tusco	82T0127	Linen White	C										
Lion's Mane	3/4" Room Darkening Tusco	82T0128	Jasmine	C										
Seaweed	3/4" Room Darkening Tusco	82T0129	Cashmere	C										
Summer Field	3/4" Room Darkening Tusco	82T0130	Jasmine	C										
Tuscan Red	3/4" Room Darkening Tusco	82T0131	Terra Cotta	C										
Denim	3/4" Room Darkening Tusco	82T0132	Periwinkle	C										
Rain Drop	3/4" Woven Translucent	82T0133	Periwinkle	G	3 ^{3/8}	3 ^{4/8}	3 ^{5/8}	3 ^{6/8}	4	4 ^{1/8}	20"	84"	20"	66"
Autumn	3/4" Woven Translucent	82T0134	Terra Cotta	G										
Castle Stone	3/4" Woven Translucent	82T0135	Cashmere	G										
Cotton	3/4" Woven Translucent	82T0136	Brilliant White	G										
Creme Brulee	3/4" Woven Translucent	82T0137	Jasmine	G										
Vanilla	3/4" Woven Translucent	82T0138	Cashmere	G										
Majestic Violet	3/4" Woven Room Darkening	82T0139	Linen White	G	3 ^{2/8}	3 ^{4/8}	3 ^{5/8}	3 ^{6/8}	3 ^{7/8}	4 ^{1/8}	20"	84"	20"	54"
Platinum	3/4" Woven Room Darkening	82T0140	Ash Gray	G										
Gold Rush	3/4" Woven Room Darkening	82T0141	Jasmine	G										
Bonsai	3/4" Woven Room Darkening	82T0142	Linen White	G										
Cotton	3/4" Woven Room Darkening	82T0143	Brilliant White	G										
Creme Brulee	3/4" Woven Room Darkening	82T0144	Jasmine	G										
Amber Wave	3/4" Translucent	82T0145	Linen White	F	3 ^{4/8}	3 ^{5/8}	3 ^{7/8}	4 ^{1/8}	4 ^{2/8}	4 ^{4/8}	20"	84"	20"	72"
Cotton	3/4" Translucent	82T0146	Brilliant White	F										
Creme Brulee	3/4" Translucent	82T0147	Jasmine	F										
Vanilla	3/4" Translucent	82T0148	Cashmere	F										



R Values

R Values Chart and Definitions

Fabric Type	Winter R-Value	Summer R-Value	Summer Shading Co-ef	% UV Blockage	Sound Absorption
3/4" Single Cell Blackout	5.00	4.35	0.36	99%	0.40
1/2" Double Cell Translucent	4.35	2.90	0.35	98%	0.40
3/4" Single Cell Translucent	3.60	2.90	0.44	98%	0.55
3/4" Semi Sheer	2.63	2.05	0.43	95%	0.10

*R-Value is the measure of how much a shade is resistant to heat flow. A high rating means more insulation.

*Summer Shading Coefficient is the level of heat that passes through a shaded window compared to a clear window. Less heat is transferred the lower the number...less heat means translates to a cooler room.

*% UV Blockage measures how good something prevents harmful ultraviolet rays from coming through the window. A higher percentage number means more UV rays are being blocked.

*Sound Absorption measures the level of sound that is absorbed by a shade. The higher the number, the more sound is absorbed.



Range Expectations

Distance from shade to be controlled

QMotion® transmitters are expected to work from over 30 feet away. While your individual results will vary, and may be less in some environments, many customers have reported even better results.

The QMotion® Timer Remote is a special function device and under FCC guidelines may not transmit at the same power as others. Range for this is typically over 10 feet.

We recommend the use of a Qrelay when the transmission range of a device is not sufficient.

Transmitter	Normal (ft)
Single Channel	30
Multi Channel	30
USB Timer	10
Qconnect	50
Qrelay	30

****Remember each installation is unique, height of the window, interference and other factors may effect this expectation.****





QMotion® Controls

QMotion® Single Channel 5 Button Remote

- 5 buttons to support up, down, 25%, 50%, 75%
- Magnetic back for simple storing to wall plates
- Controls unlimited number of shades in a group
- Normal remote range: 30 feet
- 25%, 50%, 75% settings can be reprogrammed as three custom intermediate positions

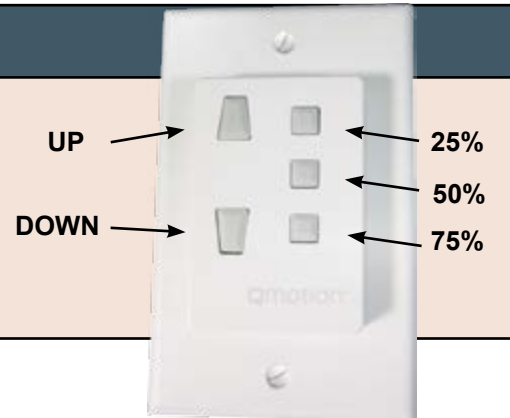

QMotion® Programmable Timer Remote

- Programmed automated settings in addition to the single channel 5 button remote controls
- Low transmission power, must locate close to shades or Qrelay
- Supports as many as 6 events
- Windows PC programmable
- Time of day, days of week, sunrise/sunset settings
- Normal remote range: 10 feet



QMotion® Multichannel Remote

- Up to 6 individual or group settings
- All shades programmed to a multichannel remote are controlled together with an "ALL" button on same remote
- Supports up, down, 25%, 50%, 75% actions
- LED light feedback
- Motion activated zone indicated when remote is moved
- Normal remote range: 30 feet
- 25%, 50%, 75% settings can be reprogrammed as three custom intermediate positions





QMotion® Qconnect

The Qconnect Interface is a bridge between our language and most building or home automation systems. With drivers for many popular systems, and easy programming tools, clients can easily drive QMotion® Automated shades with their new or existing control systems.

- RS-232 serial
- RS-485 serial
- Dry contact interface
- 15 channel
- 9v DC power supply or power over CAT 5
- Desk or wall mountable
- 4,000 foot wiring range
- Normal remote range: 50 feet

Qconnect is compatible with:



QMotion® Qrelay

Each installation is different, and environmental factors may have an effect on transmission. In some cases, a Qrelay may be helpful in improving signal reception. To consider in advance, if a room is over 12'x12', or a shade is 30' from where it would be controlled, the Qrelay is recommended. As these dimensions increase, the Qrelay will become increasingly helpful, and spaces significantly larger may even benefit from more than one Qrelay.

- Extends range of all QMotion remotes.
- Use as many as required in an installation (no limits)
- Powered from a wall outlet or from a powered USB port
- Two modes of operation "Zone Specific" and "Echo"
 - Zone specific mode allows individual remotes to be learned to the repeater
 - Echo mode repeats all valid Qmotion remote commands
- Normal remote range: 30 feet





QMotion® Hembar Activation

QMotion® Honeycomb Shades incorporate the same patented and unique tug features that allow QMotion® Roller Shades to open with just a short tug, or be lowered without the remote.

Tug the hembar less than 1”

- Shade opens to next highest preset position
(example: shade moves from 75% to 50%)

Tug the hembar downward between 1” - 3”

- Shade moves to full open

Tug the hembar MORE than approximately 3”

- Shade remains at position stopped until pulled or sent up with a remote

Two successive tugs MORE than approximately 2”

- Shade moves to full open





QMotion® Wall Docking Station

For the convenience of the user, consider QMotion® Wall Docking Stations. Available in Single, Double or Triple gang versions, these wall plates are built to install on a wall as a place to retain the transmitters used in a project. Remote controls hold in place on the Docking Station via a strong magnet, and allow the remote controls to be used as a wall switch for a third level of control for the shades. Wall plates are flush mounted and do not require routing a hole in drywall or other mounting wall finishes. For public spaces, or other places where a remote should be “permanently” attached to a wall, our Wall Station Adaptors mount around the remotes, making them virtually impossible to remove without a screwdriver.



Single Wall Station

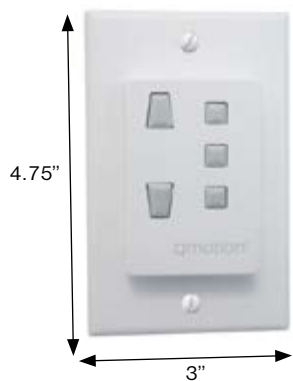

Double Wall Station

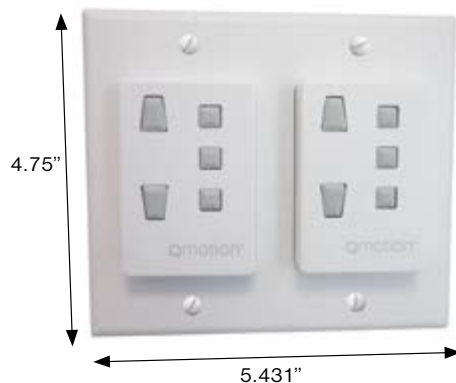

Triple Wall Station



Multichannel-Single

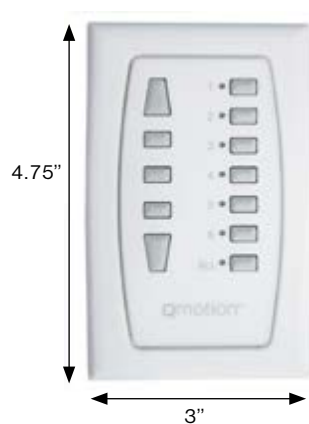

Multichannel-Double

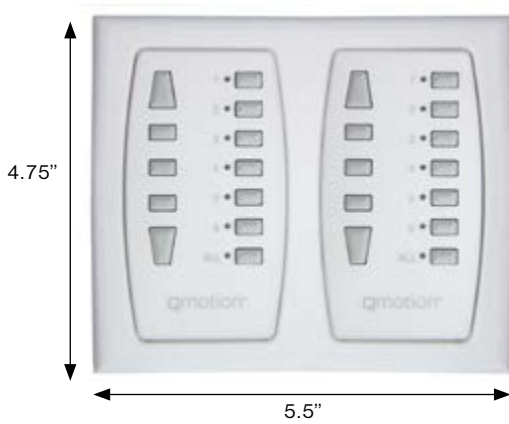

Wall Station Adaptors





QMotion® Measurement Instructions

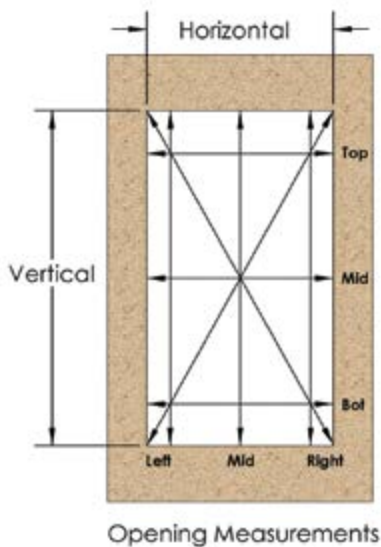

Inside Mount



Outside Mount



Measure and assess area to be covered:

- Measure opening to be covered vertically and horizontally in three places.
- If vertical measurements vary more than $\frac{1}{2}$ " we recommend an outside mount.
- If horizontal measurements vary more than $\frac{1}{2}$ " we recommend an outside mount.
- Measure and compare diagonals to determine if opening is square.
- If corner to corner diagonal measurements vary more than $\frac{1}{2}$ " we recommend an outside mount.
- Use a level to determine if opening is plumb and square.
- If out of square or out of plumb by more than $\frac{1}{2}$ " we recommend an outside mount.

Measurement rules:

- Make all measurements to the nearest $\frac{1}{16}$ ". On inside mount applications, round down.
- Measure all windows, even if they appear to be the same size.

Considerations:

- There must be significant support structure to hold the shade, i.e. wood, concrete, anchored drywall, etc.
- For drywall you may use heavy duty auger style drywall anchors rated sufficient for the weight of the shade.
- Standard roll or reverse roll are available. Reverse roll may be needed to free shade path from obstructions, i.e. handles, locks, alarm sensors, molding, trim, etc.



QMotion® Measurement Instructions (cont.)

Required order form measurements for **INSIDE MOUNT:**

- Use the top horizontal measurement for **TOP WIDTH**. This is outside of end cap to outside of end cap.
- Use the largest vertical measurement for **HEIGHT**.
- Measure and record **DEPTH**. Use the minimum distance from the outside of opening to the window including window mullions if they exist. This is important in determining if the shade and fascia will protrude into the room and out of the opening.

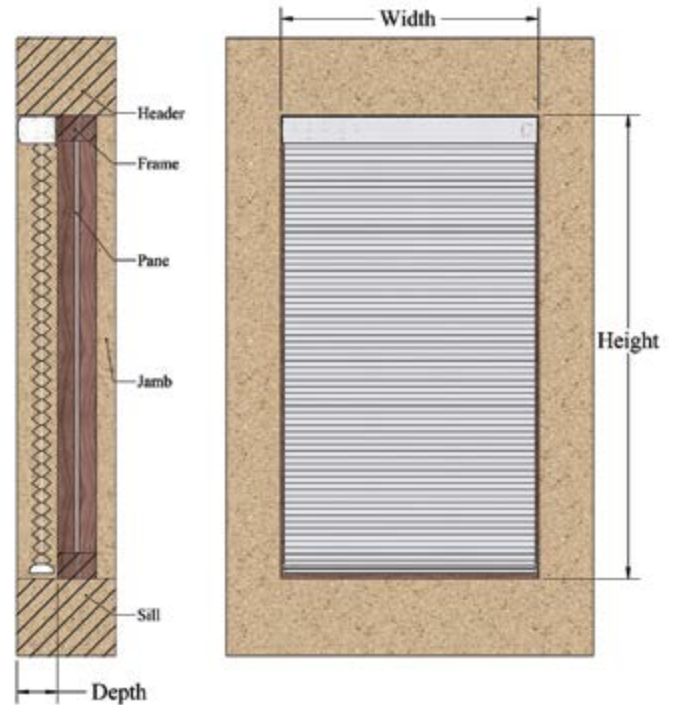

Required order form measurements for **OUTSIDE MOUNT:**

- Determine **FABRIC WIDTH** based on largest horizontal measurement **PLUS** total desired side overlap.
 - Minimum 1.5" side overlap is recommended.
 - Establish **WIDTH** dimension by adding $\frac{3}{8}$ " to the **FABRIC WIDTH**. This is outside of end cap to outside of end cap. (Note: End caps extend beyond **FABRIC WIDTH** by $\frac{3}{16}$ " on each side.)
 - Determine **HEIGHT** by measuring the largest vertical measurement and adding 2" + desired **Sill** overlap.
- Minimum 1" Sill overlap is recommended.

